

10 71 13/IND

BuyLine 2902

2009



**INDUSTRIAL  
LOUVERS Inc.**

# Sun Control Devices

Custom Aluminum Fabrication of

Horizontal & Vertical Sunshades • Lightselves • Trellises

FOR COMPLETE  
INFORMATION  
VISIT OUR WEBSITE

[IndustrialLouvers.com](http://IndustrialLouvers.com)

COVER: Teel Plastics, Baraboo, WI  
Johns Creek MOB, Lithia Springs, GA



INDUSTRIAL  
LOUVERS Inc.



**Johns Creek MOB  
Lithia Springs, GA**

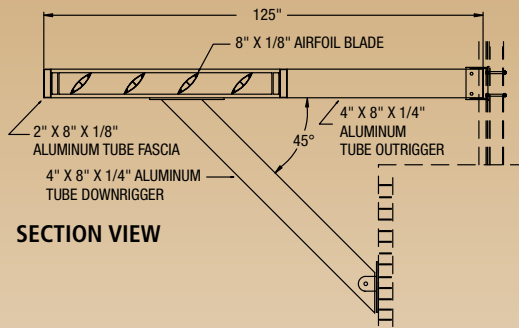

SECTION VIEW

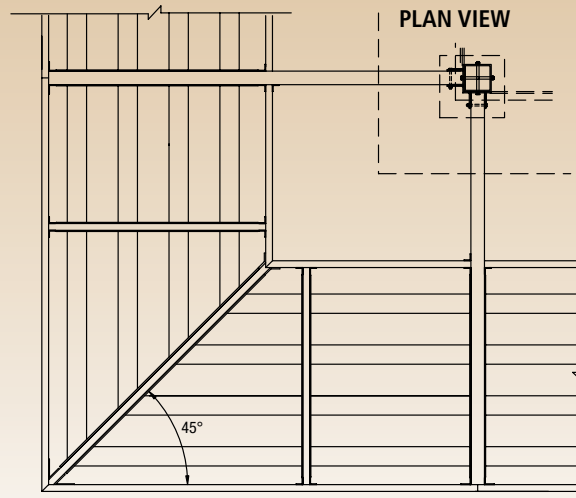

Aesthetics • Form • Function



**INDUSTRIAL  
LOUVERS Inc.**

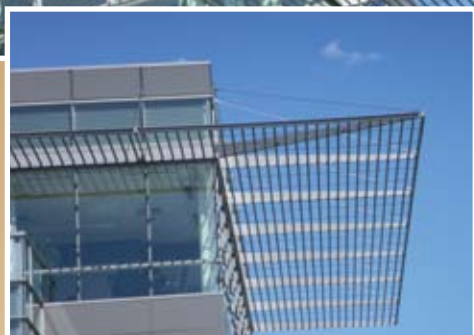

**Lear Corporation  
Plymouth, MI**

**SECTION VIEW**

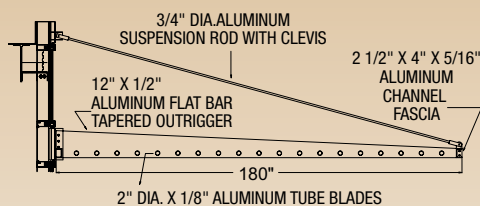

**PLAN VIEW**

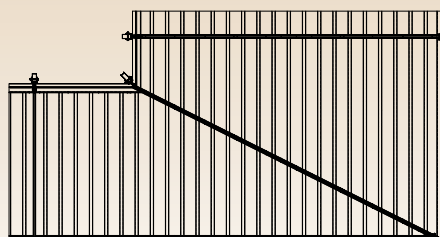

**CH Robinson  
Eden Prairie, MN**

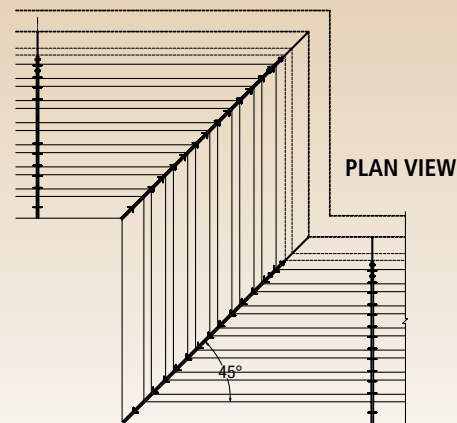
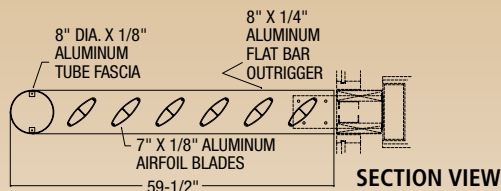

*Custom Sunshades*



**INDUSTRIAL  
LOUVERS Inc.**



### St. Catherine's College St. Paul, MN

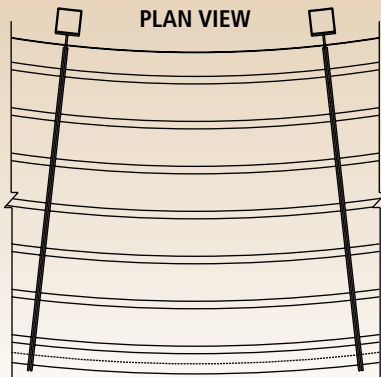
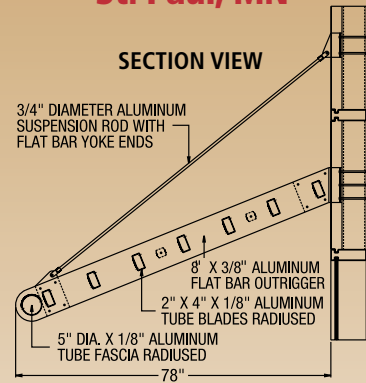

### Big Bend Community College Moses Lake, WA

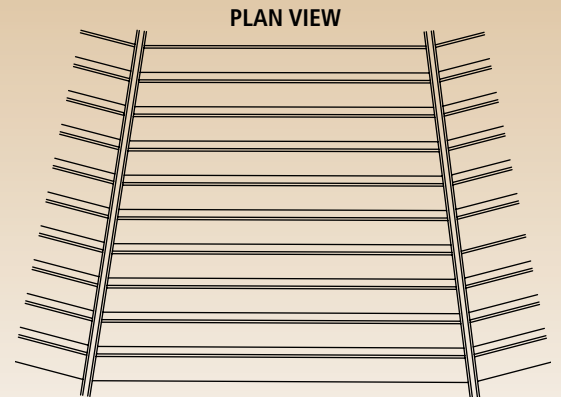
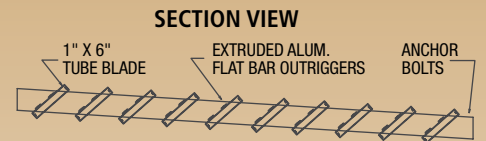

*Custom Sunshades*



*Parker  
Adventist  
Hospital  
Parker, CO*



*Horn Memorial  
Hospital,  
Ida Grove, IA*



*Citadel  
Business Park,  
Commerce, CA*

**10 71 13/IND**  
**BuyLine 2902**



**INDUSTRIAL  
LOUVERS Inc.**



*Rack Room Shoes,  
Charlotte, NC*



*Children's Hospital of the  
King's Daughters,  
Newport News, VA*

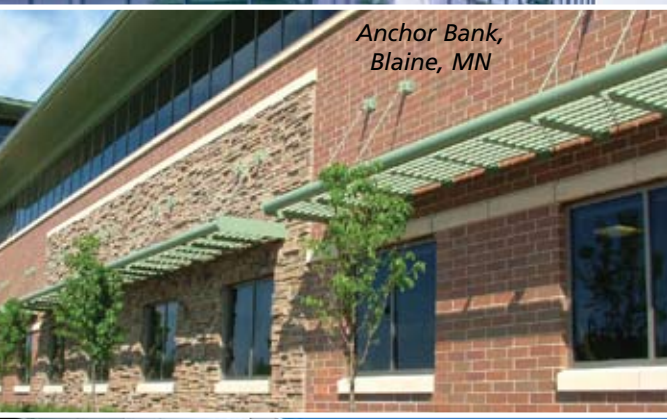

*Anchor Bank,  
Blaine, MN*



*Simmons College,  
Boston, MA*



*C & D Aerospace,  
Huntington  
Beach, CA*



*Inova Heart Institute  
Falls Church, VA*

**Sunshade Gallery**

## Blade Profiles

The blade profiles shown below are standard extruded aluminum profiles supplied by ILI. ILI can also create custom blade shapes and sizes for your specific project requirements.



*Curved Blade*  
6" to 10"



*Airfoil Blade*  
3" to 9.5"



*Large 3 piece Airfoil Blade*  
10" to 18"

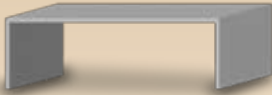

*Channel*  
2" to 8"



*Circular Tube*  
1" to 8"

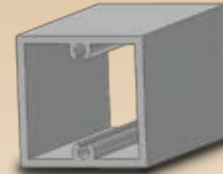

*Square Tube*  
2" to 4"

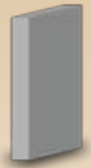

*Rectangular Flat Bar*  
2" to 12"



*Rectangular Tube*  
2" to 12"

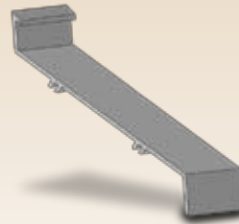

*Standard Blade*  
4", 6"



*RT Profile*  
4"

Visit [www.IndustrialLouvers.com](http://www.IndustrialLouvers.com) for a Complete List of Parts and Capabilities

## Fascia Profiles

The fascia element adds the finishing touch to your custom designed sunshade. Below are four typical profiles commonly used.

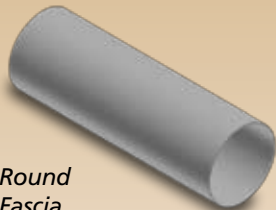

*Round Fascia*



*Bullnose Fascia*

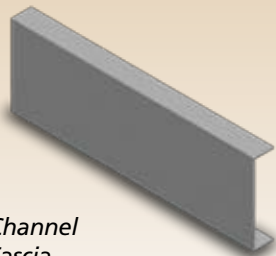

*Channel Fascia*

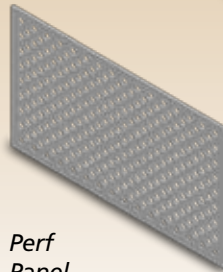

*Perf Panel*

## Suspension Rod

Suspension rods may be required in certain cases to assist in supporting the sunshade or they may be added simply as an aesthetic feature.



# Outrigger Profiles

10 71 13/IND  
BuyLine 2902

The following is just a sampling of typical outrigger profiles available from ILI. Other custom shaped outriggers made from aluminum sheet or flat bar are readily available in a wide variety of shapes and sizes.

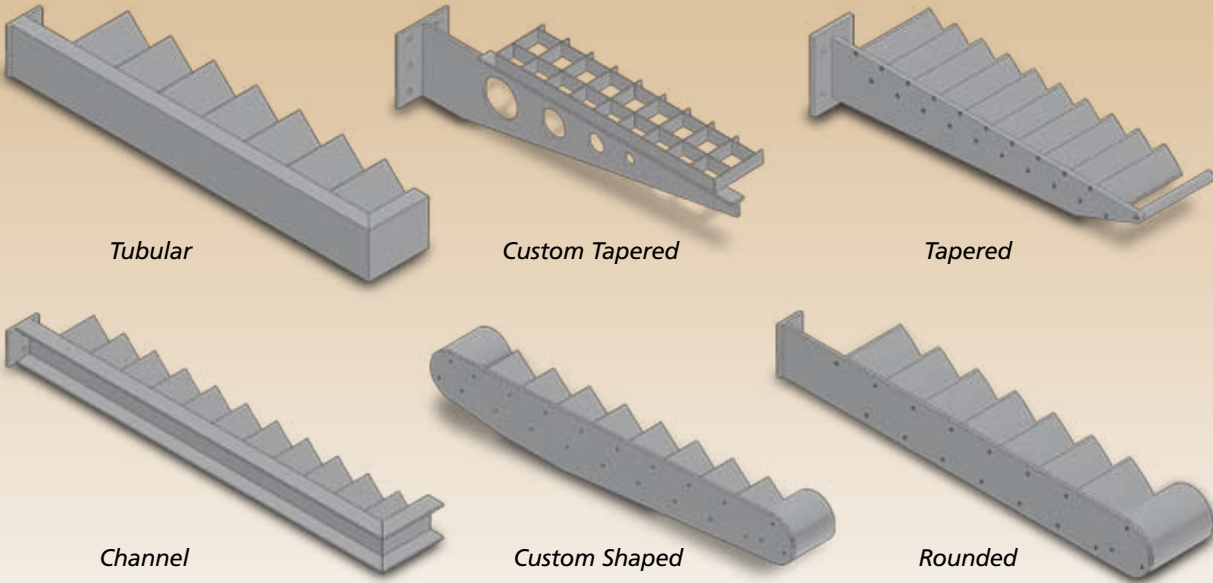

Visit [www.industrialLouvers.com](http://www.industrialLouvers.com) for a Complete List of Parts and Capabilities

# Mounting Options

Certain design criteria must be considered when mounting sunshades to buildings such as wind and snow loads, local building codes and type of substrate the sunshade is connecting to. Below are some of the more common mounting options available.

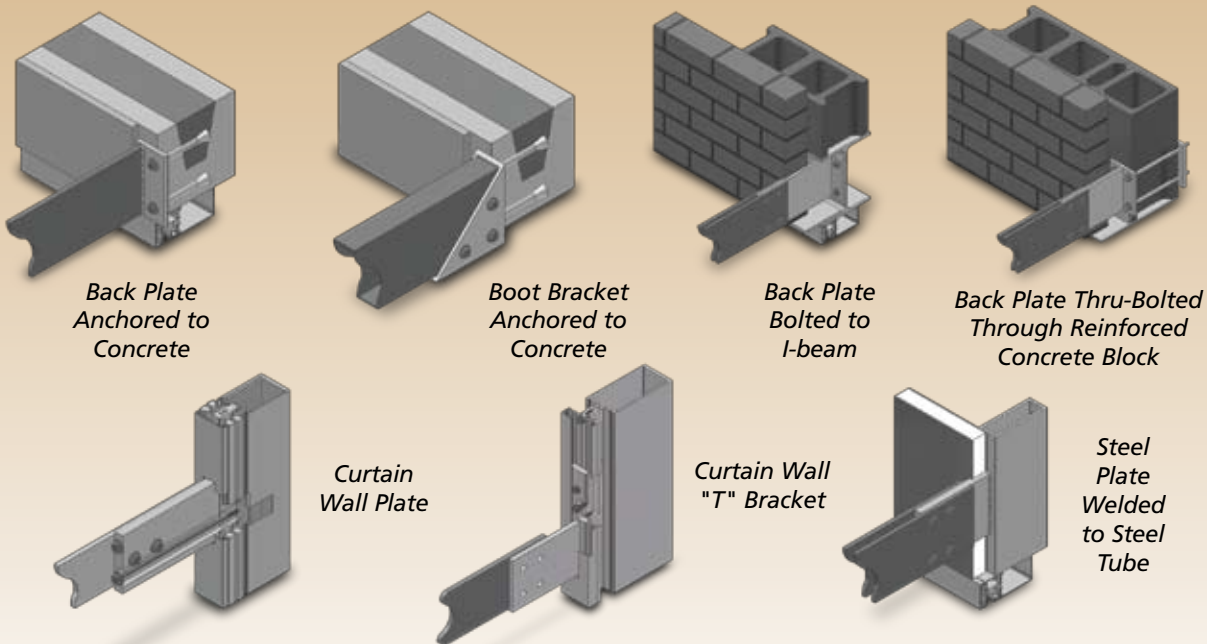

Outrigger Profiles — Mounting Options



Teel Plastics  
Baraboo, WI



511 South 7th Street  
Delano, MN 55328  
Phone (763) 972-2981  
Fax (763) 972-2911  
[www.industriallouvers.com](http://www.industriallouvers.com)  
[ilinfo@industriallouvers.com](mailto:ilinfo@industriallouvers.com)

**800-328-3421**

## About Finishing at Industrial Louvers...

Our in-house painting facility, Industrial Finishing, Inc., is solely dedicated to serving Industrial Louvers finishing needs. This arrangement allows for less material handling, thus minimizing the chance for damaging product during the finishing process. ILI offers a wide variety of standard, exotic and custom mixed colors for you to choose from.

**KYNAR® 500  
HYLAR® 5000  
ANODIC FINISHES**



*For further information on ILI's finishing capabilities, call (763) 972-2981 and ask for the "Finish Guide"*